

Couplings

- Main Power offers a variety of coupling sizes and styles for almost any piping application.
- Consisting of three basic components — the housing, the gasket, and bolts and nuts — Main Power provide a simple, economical method for joining carbon steel, copper, stainless steel, aluminum, HDPE and PVC plastic piping systems.
- Main Power provide designers with versatility not found in other pipe joining methods. Victaulic rigid and flexible couplings can be combined to allow for thermal growth within the system. Additionally, the use of three consecutive flexible couplings reduces noise and vibration and eliminates costly specialty noise dampeners.

Advanced Groove System **AGS**



For 350–600mm/14–24" piping systems
Main Power offers Advanced Groove System (AGS) couplings

Rigid Coupling

UL FM UIC VdS LPCB



Standard Flexible Coupling

UL FM UIC VdS LPCB



Flexible Coupling

UL FM UIC VdS LPCB



Large Diameter Pipe Coupling



Adapter ANSI Class 150

UL FM UIC VdS



Adapter ANSI Class 300

UL FM UIC



Reducing Coupling

UL FM UIC VdS LPCB



Snap-Joint® Coupling



Couplings

Snap-Joint Coupling

For Complete Information
Request Publication



Size		Max. Work Pressure *	Max. End Load *	Allow. Pipe End Sep. *	Dimensions			Approx. Wgt. Each
Nominal Size mm Inches	Actual Outside Dia. mm Inches				X mm Inches	Y mm Inches	Z mm Inches	
25 1	33.4 1.315	2065 300	1825 410	0 - 1.6 0 - 0.06	70 2.75	83 3.25	44 1.75	0.4 0.8
32 1¼	42.2 1.660	2065 300	2890 650	0 - 1.6 0 - 0.06	79 3.13	95 3.75	48 1.88	0.5 1.1
40 1½	48.3 1.900	2065 300	3780 850	0 - 1.6 0 - 0.06	89 3.50	114 4.50	48 1.88	0.8 1.7
50 2	60.3 2.375	2065 300	5920 1,330	0 - 1.6 0 - 0.06	102 4.00	121 4.75	48 1.88	0.8 1.7
65 2½	73.0 2.875	2065 300	8680 1,950	0 - 1.6 0 - 0.06	121 4.75	149 5.88	48 1.88	1.1 2.5
80 3	88.9 3.500	2065 300	12840 2,885	0 - 1.6 0 - 0.06	137 5.38	159 6.25	48 1.88	1.3 2.8
100 4	114.3 4.500	2065 300	21225 4,770	0 - 3.2 0 - 0.13	175 6.88	197 7.75	54 2.13	2.5 5.5
125 5	141.3 5.563	2065 300	32440 7,290	0 - 3.2 0 - 0.13	222 8.75	241 9.50	54 2.13	4.4 9.8
150 6	168.3 6.625	2065 300	46060 10,350	0 - 3.2 0 - 0.13	251 9.88	270 10.63	54 2.13	4.9 10.7
200 8	219.1 8.625	2065 300	77875 17,500	0 - 3.2 0 - 0.13	311 12.25	330 13.00	60 2.38	6.9 15.3

- Designed for quick disconnect service
- Mated housings are hinged with an attached locking handle for assembly
- Pressure rated up to 2065 kPa/300 psi
- Sizes from 25–200 mm/1–8"

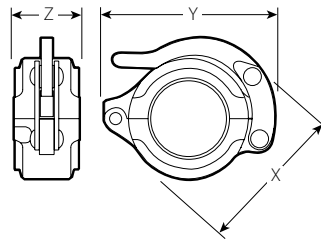

TYPICAL FOR ALL SIZES